

Key Design Principles:

It is proposed that the development would be small scale and suitable for Ashton Keynes village and conservation area setting.

A variety of house sizes and styles reflecting Cotswolds vernacular are proposed.

Key driver of the scheme is to provide safe and secure drop off for the school and teacher parking to alleviate Gosditch traffic issues.

40% affordable housing including share ownership, starter homes, bungalows and social rented, subject to viability.

Area of public open space proposed throughout site providing public amenity, an area for landscape enhancement through new planting and an area that creates a high quality setting.

Existing boundary hedges are proposed to be retained and reinforced with native species. New hedge planting is proposed within the development around footpath routes and elsewhere to maintain some of the rural characteristics

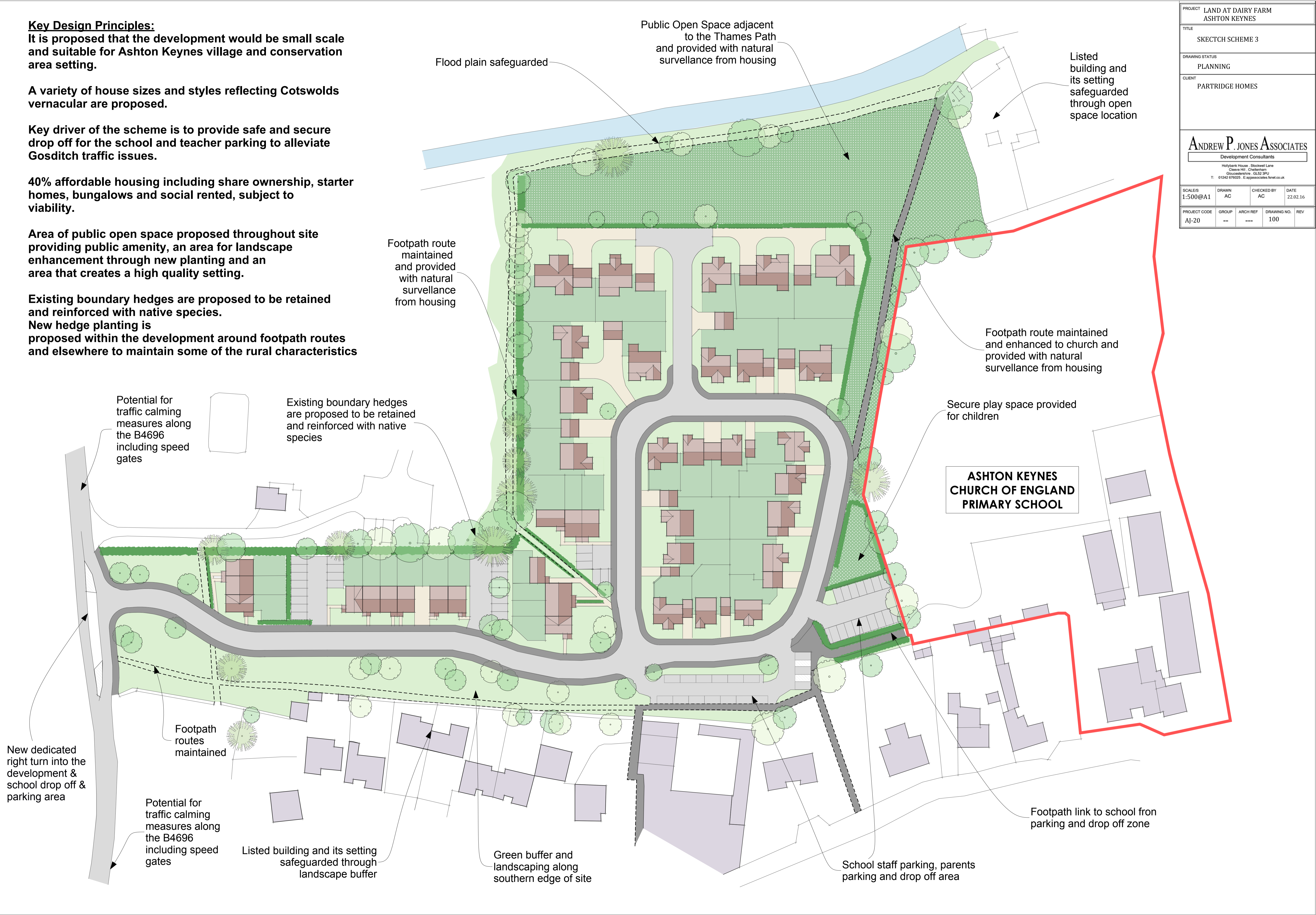

PROJECT	LAND AT DAIRY FARM ASHTON KEYNES		
TITLE	SKETCH SCHEME 3		
DRAWING STATUS	PLANNING		
CLIENT	PARTRIDGE HOMES		
ANDREW P. JONES ASSOCIATES Development Consultants <small>Hollybank House, Stockwell Lane Cleveley Hill, Chatterham Gloucestershire, GL52 3PQ T: 01242 876225 E: apjassociates@onetel.co.uk</small>			
SCALE/S	DRAWN	CHECKED BY	DATE
1:500@A1	AC	AC	22.02.16
PROJECT CODE	GROUP	ARCH REF	DRAWING NO. REV
AJ-20	--	---	100